

LUMBER PATTERN DATA SHEET

BEVEL LUMBER PATTERNS | V1.0



LUMBER PROFILE 1/2" PLAIN SAW-TEXTURED BEVEL SIDING (S1S2E)

FIND THIS PATTERN IN OUR LUMBER PATTERN BOOK ON PAGE 21

» NOTE: Dimensioned pattern drawings are drawn to scale and presented at 100% unless otherwise indicated.

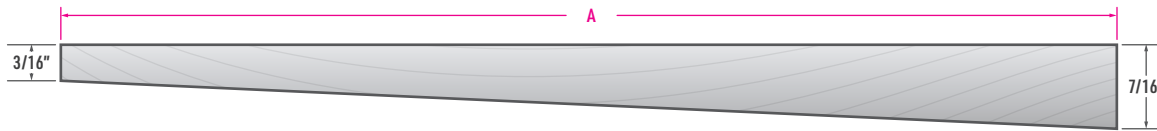

SCAN HERE

Get a digital copy of our *Lumber Pattern Book* by scanning the QR Code or by visiting our website at: westernwoodsinc.com

PROFILE VIEW

INSTALLED VIEW



SIZE OPTIONS

| NOMINAL SIZE | PATTERN NO. | A | B | CONVERSION FACTOR |
|--------------|-------------|--------|---|-------------------|
| 1/2 x 4 | 320R | 3 3/8" | - | 1.60 |
| 1/2 x 5 | 321R | 4 1/2" | - | 1.43 |
| 1/2 x 6 | 322R | 5 1/2" | - | 1.34 |
| 1/2 x 8 | 323R | 7 1/4" | - | 1.28 |

DISCLAIMER: The dimensions of the delivered product is subject to change due moisture variations experienced by the product during the drying process, storage, or transportation. Site environmental conditions also apply. See page 36 for additional information. Milling variations apply. Consult your local building code for tolerances and specifics.

LUMBER PATTERN DATA SHEET

BEVEL LUMBER PATTERNS | V1.0

ALIGNMENTS

- ✓ Horizontal
- ✗ Vertical

NOMINAL SIZES

| | |
|---------|----------|
| 1/2 x 2 | 5/8 x 8 |
| 1/2 x 4 | 5/8 x 10 |
| 1/2 x 5 | 3/4 x 6 |
| 1/2 x 6 | 3/4 x 8 |
| | 3/4 x 10 |

NAIL TYPES

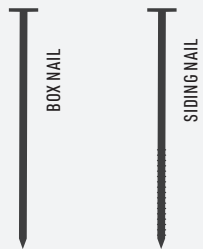

- B** BOX NAIL - Wide head flat, smooth shaft.
- S** SIDING NAIL - Wide flat head, ribbed shaft.



! WARNING: Do not nail through any of the over-lapping pieces.

DESCRIPTION

Bevel Patterns include Bungalow or ["Colonial"] patterns which are slightly thicker than Bevel. Either pattern can be used with the smooth or saw-faced surface exposed. These patterns provide a traditional-style appearance. When installing, recommend a 1" overlap [1].

NAILING PATTERNS

LEGEND

- 1** NAILS MUST PENETRATE 1 1/2" INTO SOLID WOOD.
 - A** ONE SIDING OR BOX NAILS. ONE PER BEARING, PLACE 1" FROM BOTTOM EDGE.
 - 1** POSITION LOWER NAIL 1" FROM THE BOTTOM. (OVERLAP)
 - A** HOUSE WRAP
 - B** SHEATHING
 - C** STUD
-  SIDING
 NAIL DEPTH
 NAIL

PROFILE VIEW

A profile view of the pattern before installation. *(Bevel - left; Colonial - right)*



FIND THIS PATTERN IN OUR LUMBER PATTERN BOOK STARTING ON PAGE 20

NAILING PATTERNS 6" AND NARROWER

PLAIN

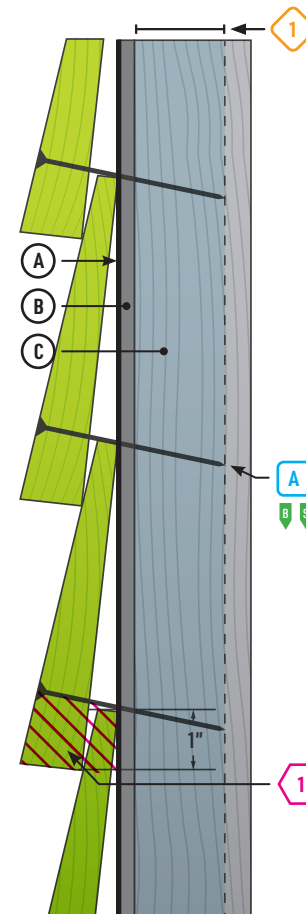

NAILING PATTERNS 8" AND WIDER

PLAIN

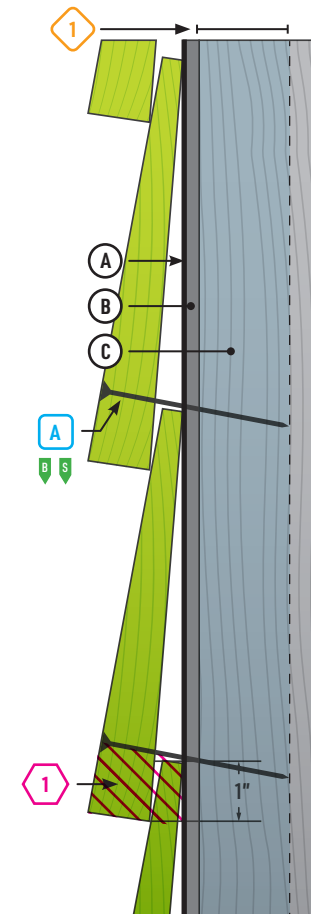

CONTENT SOURCE INSTALLATION RECOMMENDATIONS & NAILING PATTERNS PROVIDED BY WIPA.