

LUMBER PATTERN DATA SHEET

SHIPLAP LUMBER PATTERNS | V1.0



LUMBER PROFILE **WP-11 - 1" SIDING**

FIND THIS PATTERN IN OUR LUMBER PATTERN BOOK ON PAGE 15

» NOTE: Dimensioned pattern drawings are drawn to scale and presented at 100% unless otherwise indicated.

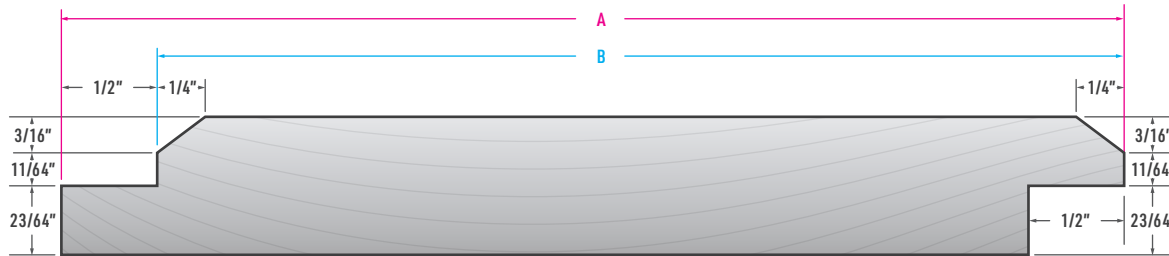

SCAN HERE

Get a digital copy of our *Lumber Pattern Book* by scanning the QR Code or by visiting our website at: westernwoodsinc.com

PROFILE VIEW



INSTALLED VIEW

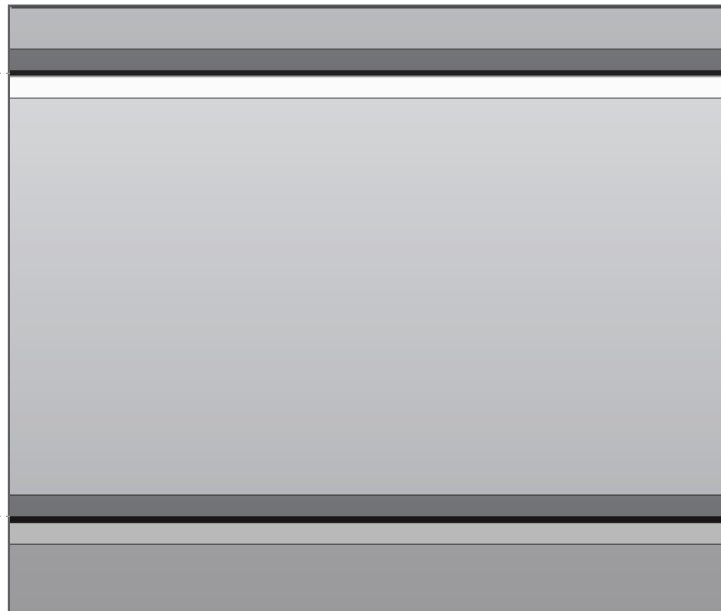

SIZE OPTIONS

NOMINAL SIZE	PATTERN NO.	A	B	CONVERSION FACTOR
1 x 6	WP-11	5 ⁷ / ₁₆ "	4 ¹⁵ / ₁₆ "	1.17
1 x 8	WP-11	7 ¹ / ₈ "	6 ⁵ / ₈ "	1.16
1 x 10	WP-11	9 ¹ / ₈ "	8 ⁵ / ₈ "	1.13
1 x 12	WP-11	11 ¹ / ₈ "	10 ⁵ / ₈ "	1.13

DISCLAIMER: The dimensions of the delivered product is subject to change due moisture variations experienced by the product during the drying process, storage, or transportation. Site environmental conditions also apply. See page 36 for additional information. Milling variations apply. Consult your local building code for tolerances and specifics.

LUMBER PATTERN DATA SHEET

SHIPLAP LUMBER PATTERNS | V1.0

ALIGNMENTS

- ✓ Horizontal
 - ✓ Vertical
- Place tongued edge **UP** in horizontal applications.

NOMINAL SIZES

3/4 x 6	1 x 4
3/4 x 8	1 x 6
3/4 x 10	1 x 8
	1 x 10
	1 x 12

NAIL TYPES

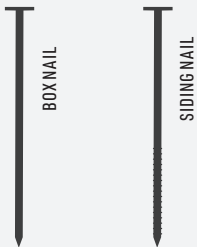

B **BOX NAIL** - Wide head flat, smooth shaft.

S **SIDING NAIL** - Wide flat head, ribbed shaft.

! WARNING: Do not nail through any of the over-lapping pieces.

DESCRIPTION

Shiplap Siding is available in a wide assortment patterns with smooth, rough, or saw-textured surface options. Shiplap siding provides a traditional-style appearance. This pattern allows for a 1/2" overlap [B]. Allow for an approximate 1/8" gap [C] when installing patterns 8" or wider.

NAILING PATTERNS

NAILING PATTERNS 6" AND NARROWER

NAILING PATTERNS 8" AND WIDER

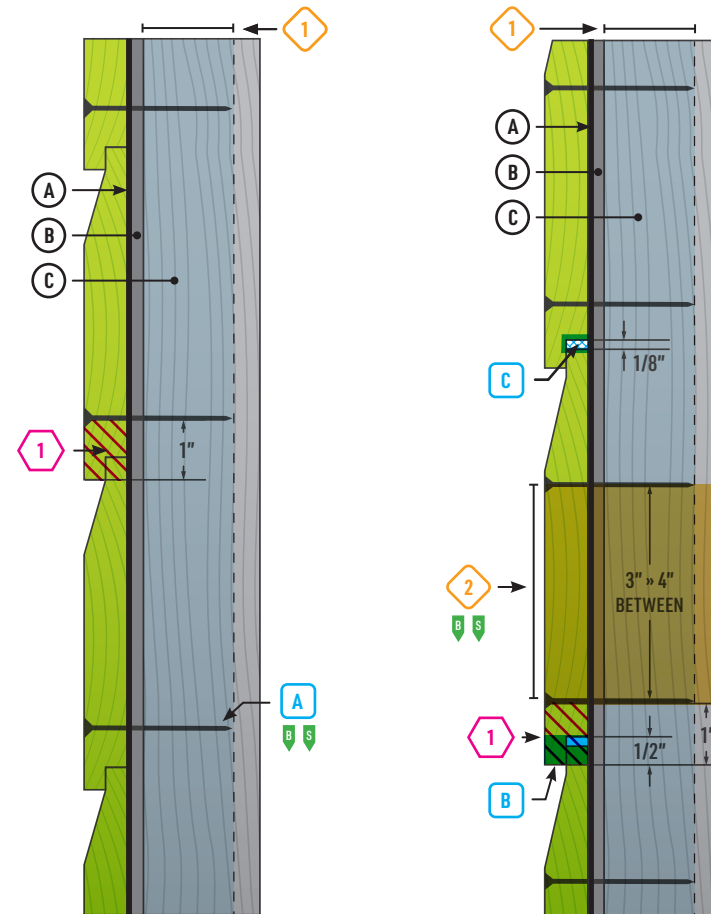

LEGEND

- 1** NAILS MUST PENETRATE 1 1/2" INTO SOLID WOOD.
- 2** USE TWO SIDING OR BOX NAILS PER BEARING 3 - 4" APART.
- A** USE SIDING OR BOX NAILS TO FACE NAIL SHIPLAP PATTERN. ONE PER BEARING.
- B** 1/2" = LENGTH OF RABBET. (OVERLAP)
- C** 1/8" = GAP FOR EXPANSION
- 1** POSITION LOWER NAIL 1" FROM THE BOTTOM.
- A** HOUSE WRAP
- B** SHEATHING
- C** STUD
- S** SIDING
- N** NAIL DEPTH
- N** NAIL

PROFILE VIEW

A profile view of the pattern before installation.



FIND THIS PATTERN IN OUR LUMBER PATTERN BOOK STARTING ON PAGE 14